



8100 Series

Heavy Duty Swing Door Operator

The 8100 Series electro-mechanical swing door operator is engineered to automate swing doors in high traffic situations.

Designed to meet market demands for dependability, low noise, and application flexibility, the 8100 Series is perfect for hospitals, supermarkets, libraries, universities, storefronts and airports with smooth trouble free operation.

Combined with Swiss precision technology and a patented control system with 32 bit processor technology, the 8100 is powerful, intelligent, and guarantees rapid and reliable door control even when complex functions are required.

As part of it's unique software platform, the 8100 can also be programmed to be utilized as a low energy operator to comply with ANSI 156.19.

Available in push or pull, surface applied or overhead concealed in clear or dark bronze anodized for single, pair or dual egress configurations.

Complies with the following standards.

ANSI/BHMA A156.19, A156.10, UL325, UL228, UL10C.

Product features

Quiet Operation

Suitable for high traffic locations

Interior or Exterior Use

Can be used on virtually any door configuration

Push to start operation

Onboard system monitoring when equipped with S.M.A.R.T. Panel LCD Display

Electric Latch Assist assures closing in areas with heavy stack conditions

Doors that require 120 degree door swing

8100 Profile

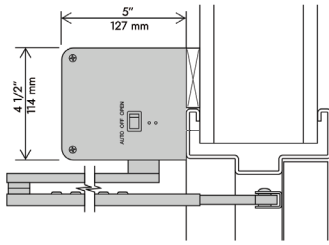

Arms

Track Arm (supplied standard)

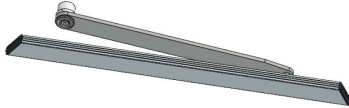

Standard Arm



Offset Arm

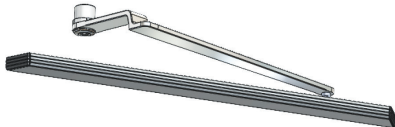

Technical Specs/Data

Header Size	5" x 4 1/2"
Motor Type	24 VAC 1/4 hp
Electrical Requirements	120 VAC @ 15 amps 60hz
Max Door Width	48" single, 96" dual
Operating Conditions	-40°F and +140°F
Power Supply	24VAC @ .5 amp for maglocks, electric strikes
Manual Opening/Closing Force	Adjustable 5 to 15 lbs.
Opening Angle - Track Arm	Up to 98 degrees (push side) Up to 180 degrees (pull side)
Opening Angle - Standard Arm	Up to 130 degrees (push side) Up to 98 degrees (pull side)
Push Reveal	Up to 12" with standard arm Up to 3" with track arm
Pull Reveal	Up to 6" with standard arm Up to 6" with track arm

Technical data subject to change without notice.

Additional Features:

- » Surface applied or overhead concealed
- » Center hung or butt hung
- » Push or Pull Same Unit
- » Non-handed
- » Various Arm Options Available
- » Single, Pair Doors or Dual Egress
- » Clear or Dark Bronze Anodized is standard, custom paint or cladding available

Alternate Configurations



8200 - Squared Header



8300 - Sloped Header for Clean Rooms



8600 - Overhead Concealed



8700 - Butt hung